

How to use the AP mode of the camera

Note:

Only professional-type cameras support AP mode, Household-type cameras do not support AP mode.

Q: What is AP mode? What does it do?

R: 1. You can configure the camera via AP mode when the camera is only connected to the power supply. For example, you can connect the power of the camera, and then through the AP mode configuration camera WIFI makes the camera direct connected to the network.

2. You can connect and use the camera via AP mode , within the range of the camera's AP.

1. Please connect power supply for cameras, do not connect network cable.
2. Open the WIFI setting of the phone and find the SSID of the camera's AP, SSID format is "IPCAM - *****" For example "IPCAM-123456", these six numbers from the camera UID middle part, the password is "01234567".

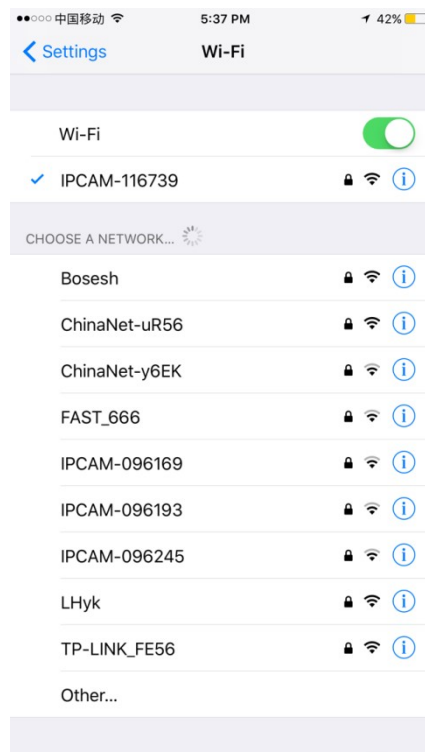

If you do not find the SSID of the camera's AP, Please reset the camera to factory settings as described in the Quick Start Guide

3. When the phone is connected to the SSID, you can run APP "CamHi" to connect the camera; click "Add Camera" - "Search camera from LAN" to add camera.

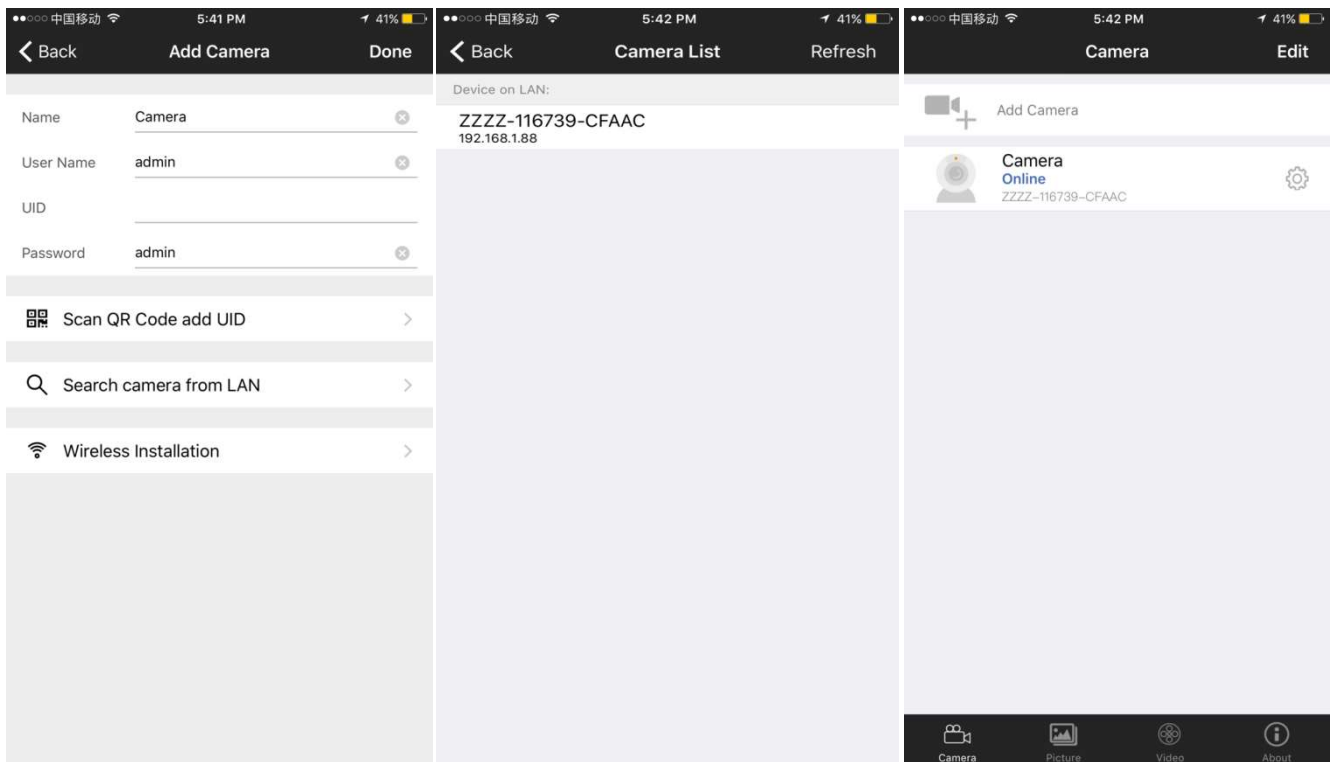

4. Now you can use the camera or configure the camera settings, such as WIFI settings.

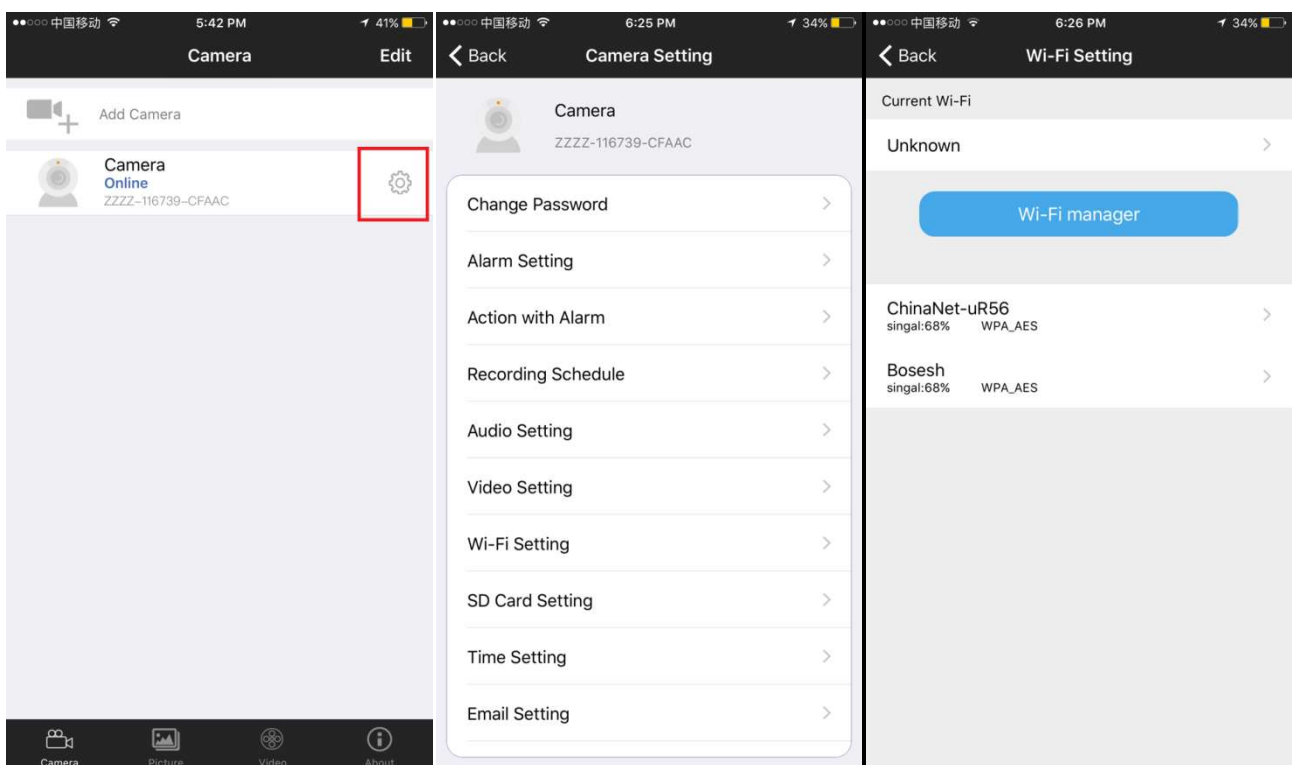

Please note: after WIFI configuration successfully in AP mode, AP mode will disappear. If you want to use the AP mode again, need to restore the camera to factory Settings.